

XSP

Stainless Steel Submersible Sewage Pump



Application

- Wastewater drainage in factories, construction sites and commercial facilities
- Drainage system in municipal sewage treatment plants
- Drainage station in residential quarters
- Municipal projects
- Methane pools and field irrigation in countryside

Pump

- Max. immersion depth: 5 m
- Max. liquid temperature: +40°C
- Liquid pH value: 4 – 10
- Liquid kinematic viscosity: $7 \times 10^{-2} \sim 23 \times 10^{-6} \text{ m}^2/\text{s}$
- Max. liquid density: $1.2 \times 10^3 \text{ kg/m}^3$

Motor

- Copper winding
- Built-in thermal protector
- Stainless steel welded shaft
- Insulation class: B
- Protection class: IP68

Identification Codes

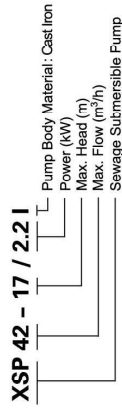

Hydraulic Performance Curves

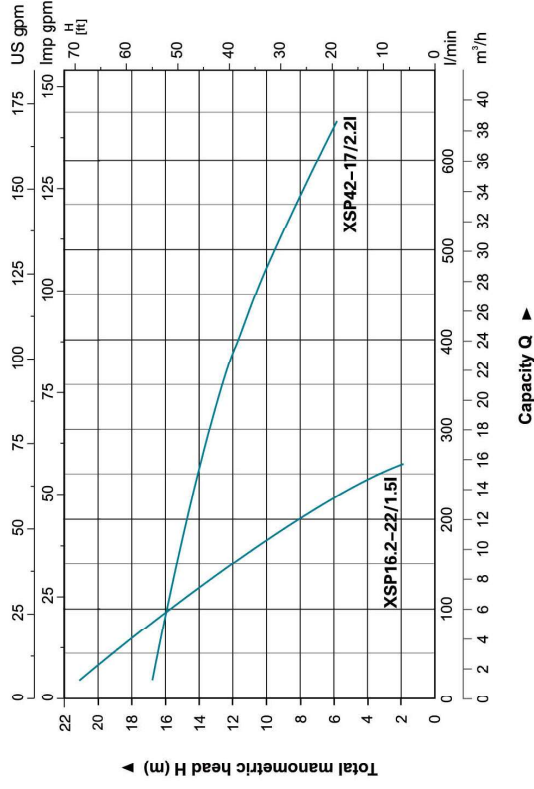

Technical Data

Model	Power		Outlet diameter (mm)	Voltage (V/Hz)	Max. flow (l/min)	Max. head (m)	Max. dia. of particle (mm)	GW (kgs)	Packing size (mm)	Quantity (PCS/20' TEU)
	(kW)	HP								
XSP16.2-22/1.5I	1.5	2.0	40	220/50	270	22	10	27.6	585x350x2-5	540
XSP42-17/2.2I	2.2	3.0	75	220/50	700	17	20	28.7	585x350x2-5	540

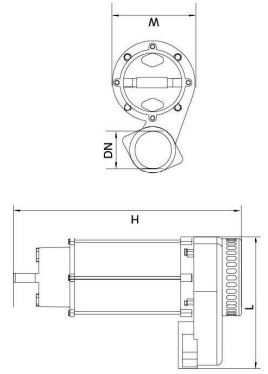

Dimension

Model	DN (mm)	L (mm)	M (mm)	H (mm)
XSP16.2-22/1.5I	1 1/2"	308	188	530
XSP42-17/2.2I	3"	302	190	535

Materials Table

No.	Part	Material	No.	Part	Material
1	Bolt	Stainless steel	31	Ball bearing	
2	Stretching washer	Stainless steel	32	Rotor	
3	Washer	Stainless steel	33	Ball bearing	
4	Bolt	Stainless steel	34	Screw	Stainless steel
5	Washer	Stainless steel	35	Washer	Stainless steel
6	Handle	Stainless steel	36	Connection part	HT 200
7	Nut	Stainless steel	37	Mechanical seal	Ceramic/Carbon
8	Protector	NR	38	O-ring	NRB
9	Cable presser	Stainless steel	39	Oil chamber cover	HT 200
10	Washer	Stainless steel	40	Screw	Stainless steel
11	Screw	Stainless steel	41	Washer	Stainless steel
12	Bolt	Stainless steel	42	O-ring	NRB
13	O-ring	NRB	43	Screw	Stainless steel
14	Screw	Stainless steel	44	Oil seal	HT 200
15	Impeller	Stainless steel	45	Impeller	Stainless steel
16	Coil	CR	46	Bolt	Stainless steel
17	Cable protector	CR	47	Washer	Stainless steel
18	Capacitor cover	HT 200	48	Washer	Stainless steel
19	Capacitor	NRB	49	Ductlet connector	ABS
20	O-ring	NRB	50	O-ring	NRB
21	Rubber washer	NRB	51	Connection nut	HT 200
22	Screw	CuZn40	52	Rubber washer	NRB
23	Stretching washer	85Mn	53	Pump body	HT 200
24	Washer	CuZn40	54	Base plate	HT 200
25	Line protector	NRB	55	Washer	Stainless steel
26	Motor cover	HT 200	56	Screw	Stainless steel
27	Thermal protector	NRB	57	Key	
28	O-ring	NRB	58	Float switch	
29	Motor stator	Stainless steel			
30	Undiluted washer	65Mn			

